



28 Samantha Drive MORNINGTON, VIC

5  
 2  
 2

### You don't have to be royalty to live like a King

Be the envy of your friends & inspect this beautiful large family home on a big 900sqm approx block complete with all the extras. Comprises:  
 5 large bedrooms (master with full ensuite including spa & WIR) + study area, formal lounge plus dining/meals area & family/rumpus room. Gas ducted heating & evaporative cooling, ceiling fans, designer kitchen with dishwasher overlooking the private outdoor entertaining area perfect for family & friends. Other features include an oversized double garage with auto door & the added bonus of a separate side driveway with heaps of backyard access with room for a caravan and/or boat. Act Quickly!

**Price:** Price by Negotiation \$640,000 - \$690,000

Stone Real Estate

Mornington

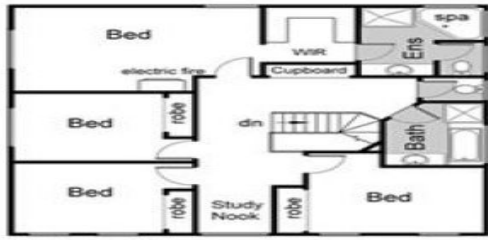

Upper Floor

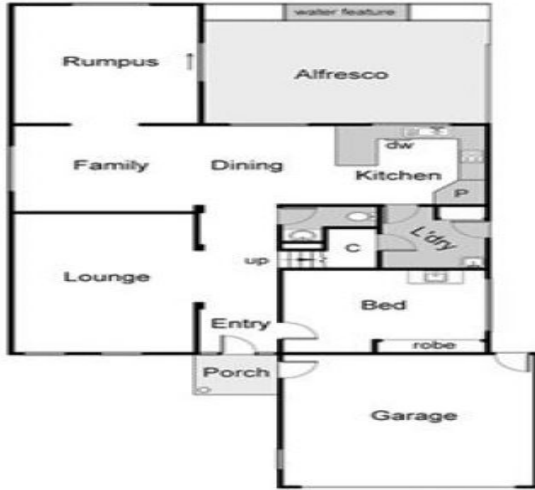

Lower Floor

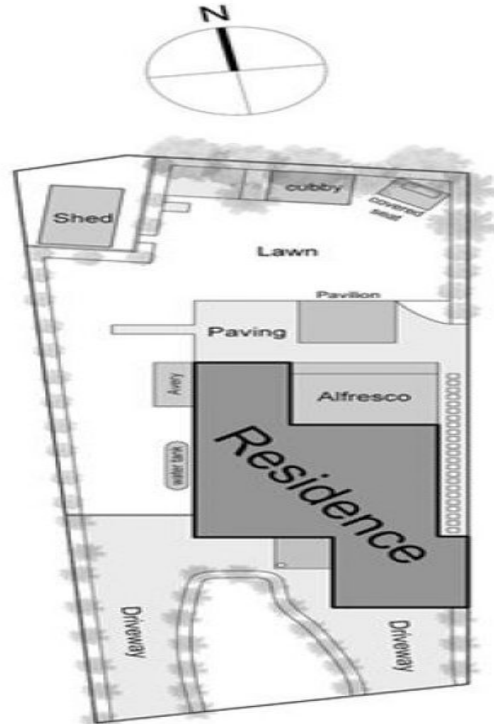

Site Plan

## 28 Samantha Drive, Mornington

This floorplan is for illustration purposes only and no warranty is given to its accuracy.  
 Purchasers are advised to carry out their own investigations.  
 Produced by realtywriters (03) 5974 1586